



# WARD PARKWAY SHOPPING CENTER

## Pad Building | End Cap Retail Space For Lease

89th & State Line Road (NEC), Kansas City, Missouri



# 1,159 SF END CAP SPACE FOR LEASE

### DEMOGRAPHICS

	1 mile	3 miles	5 miles
Estimated Population	8,368	87,793	227,301
Avg. Household Income	\$140,250	\$118,366	\$114,097

- Premier retail end cap site - FOR LEASE
- Multi-tenant building visible to over 29,000 cars per day
- Dedicated parking as well as cross-parking with entire center
- High traffic location adjacent to Ward Parkway Shopping Center
- Join Target, Trader Joe's, HomeGoods, TJ Maxx, Starbucks, Old Navy, and many more
- Great access

 [CLICK HERE TO VIEW MORE LISTING INFORMATION](#)

For More Information Contact: *Exclusive Agents*  
 PHIL PECK, CCIM | 816.412.7364 | [ppeck@blockandco.com](mailto:ppeck@blockandco.com)  
 DAVID BLOCK | 816.412.7400 | [dblock@blockandco.com](mailto:dblock@blockandco.com)





**WARD PARKWAY SHOPPING CENTER**  
 Pad Building | End Cap Retail Space For Lease  
 89th & State Line Road (NEC), Kansas City, Missouri

**1,159 SF END CAP  
 RETAIL SPACE  
 AVAILABLE**

PHOTO





# WARD PARKWAY SHOPPING CENTER

Pad Building | End Cap Retail Space For Lease  
89th & State Line Road (NEC), Kansas City, Missouri

**1,159 SF END CAP  
RETAIL SPACE  
AVAILABLE**

## SITE PLAN

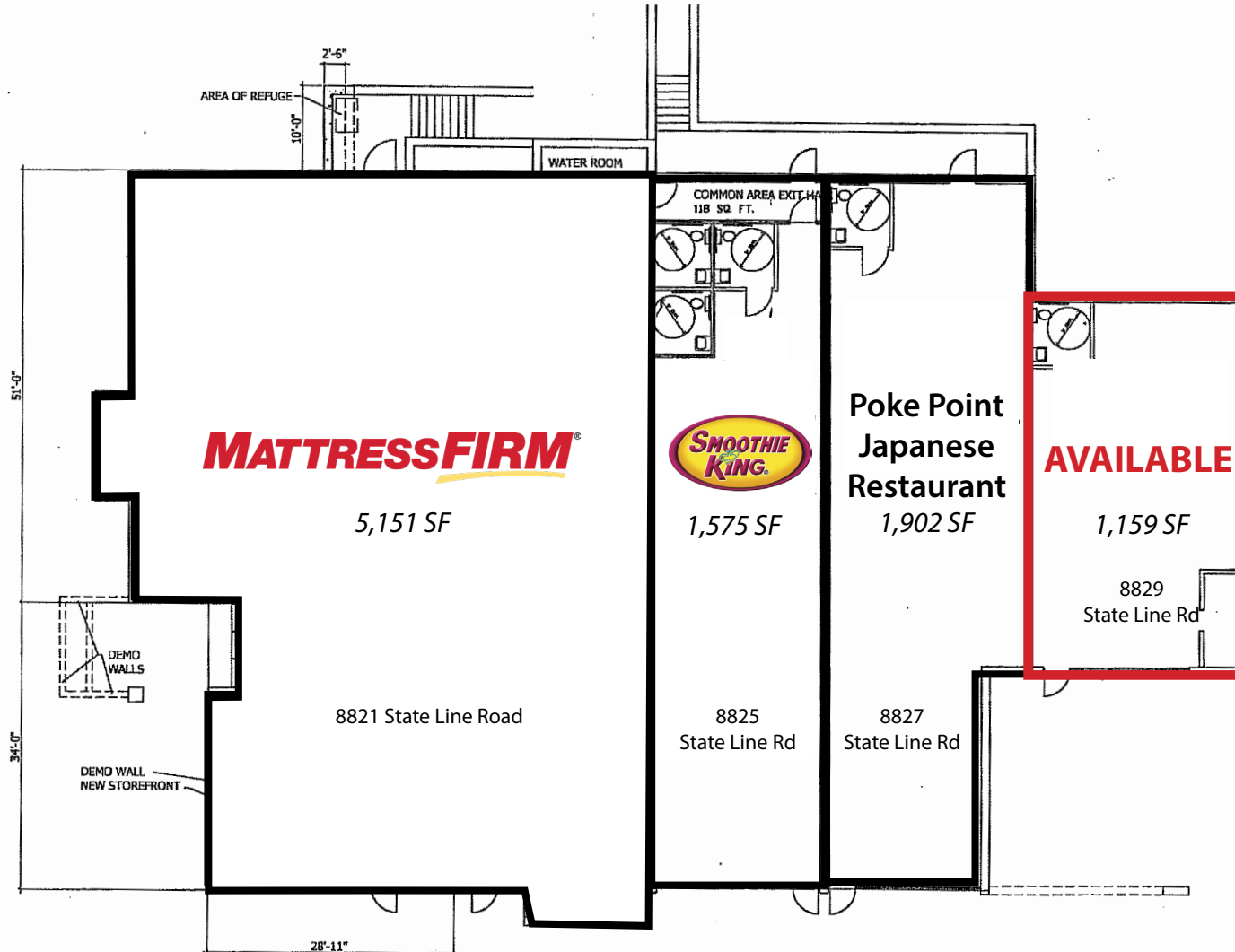

SCALE: 1/8"=1'-0"



## AERIAL

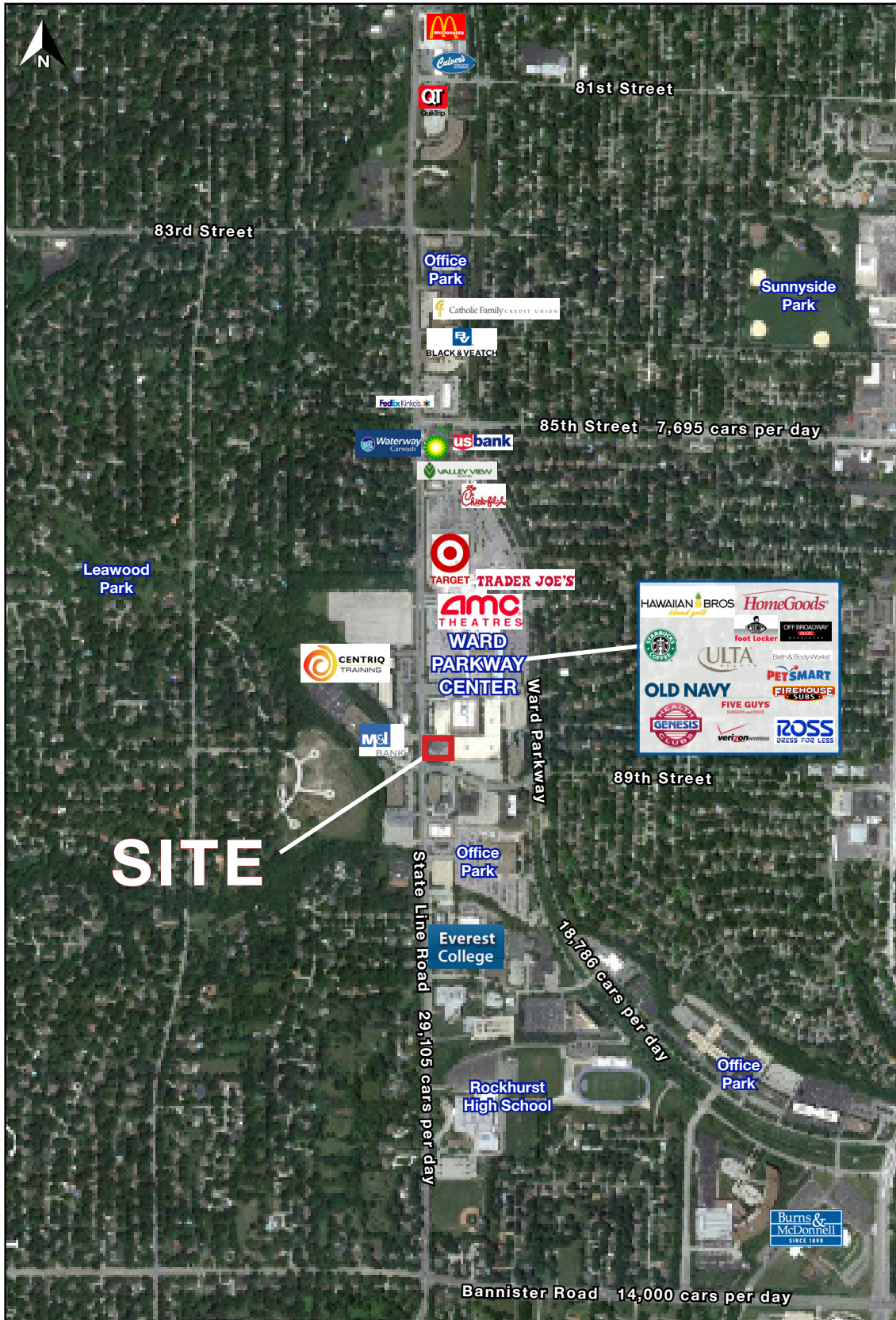



# WARD PARKWAY SHOPPING CENTER

Pad Building | End Cap Retail Space For Lease  
89th & State Line Road (NEC), Kansas City, Missouri

**1,159 SF END CAP  
RETAIL SPACE  
AVAILABLE**

## WARD PARKWAY CENTER





# WARD PARKWAY SHOPPING CENTER

Pad Building | End Cap Retail Space For Lease  
89th & State Line Road (NEC), Kansas City, Missouri

**1,159 SF END CAP  
RETAIL SPACE  
AVAILABLE**

WARD PARKWAY CENTER

**State Line Level**

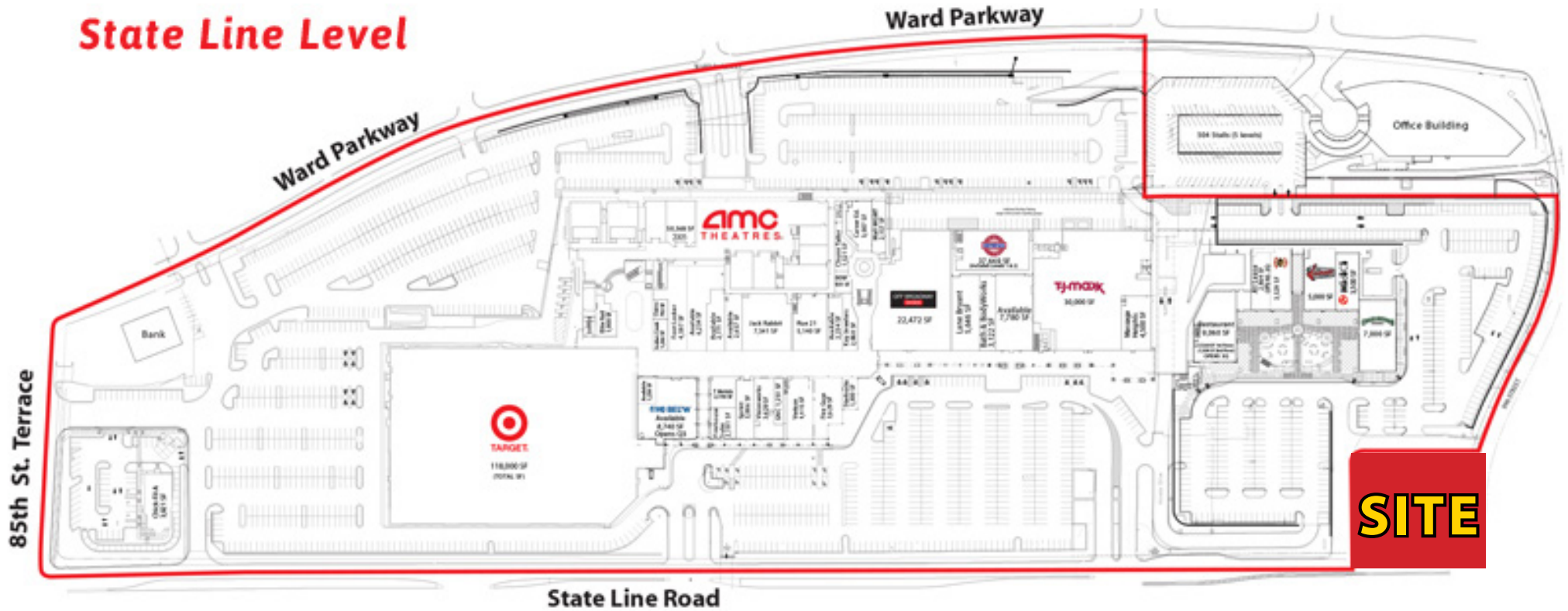



# WARD PARKWAY SHOPPING CENTER

Pad Building | End Cap Retail Space For Lease  
89th & State Line Road (NEC), Kansas City, Missouri

**1,159 SF END CAP  
RETAIL SPACE  
AVAILABLE**

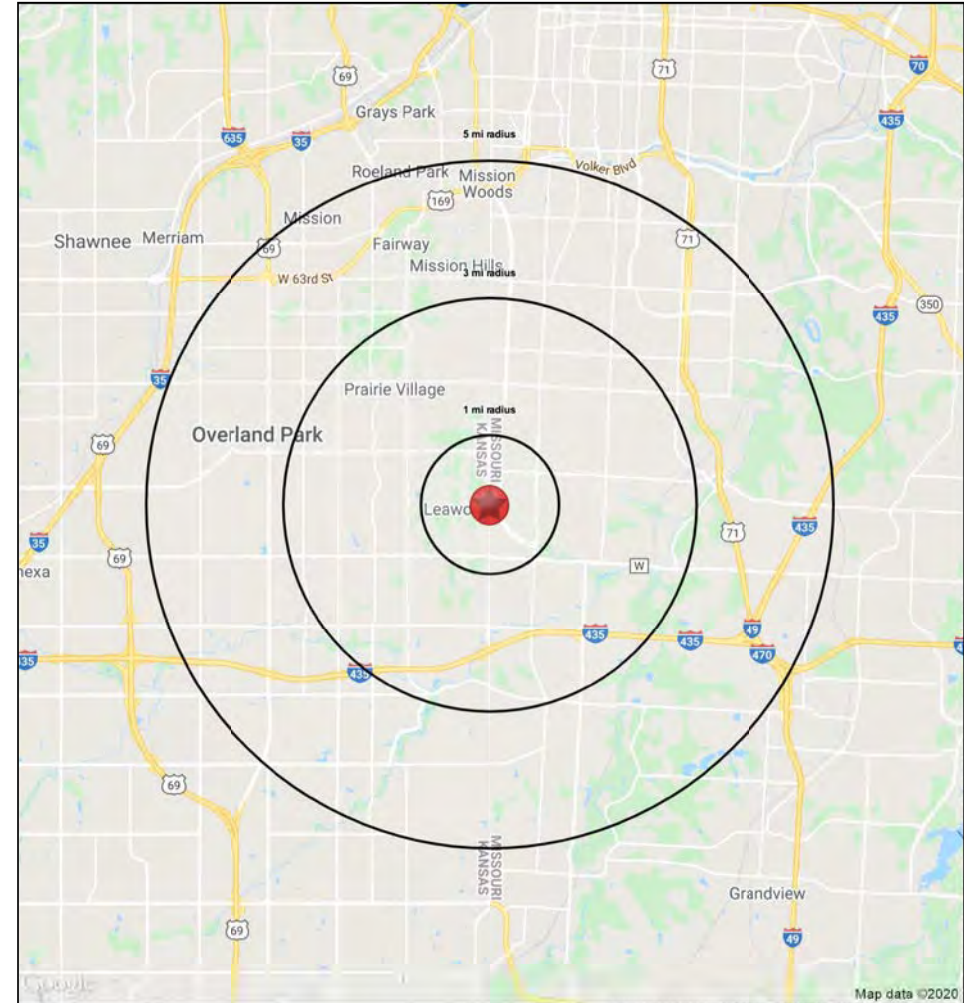
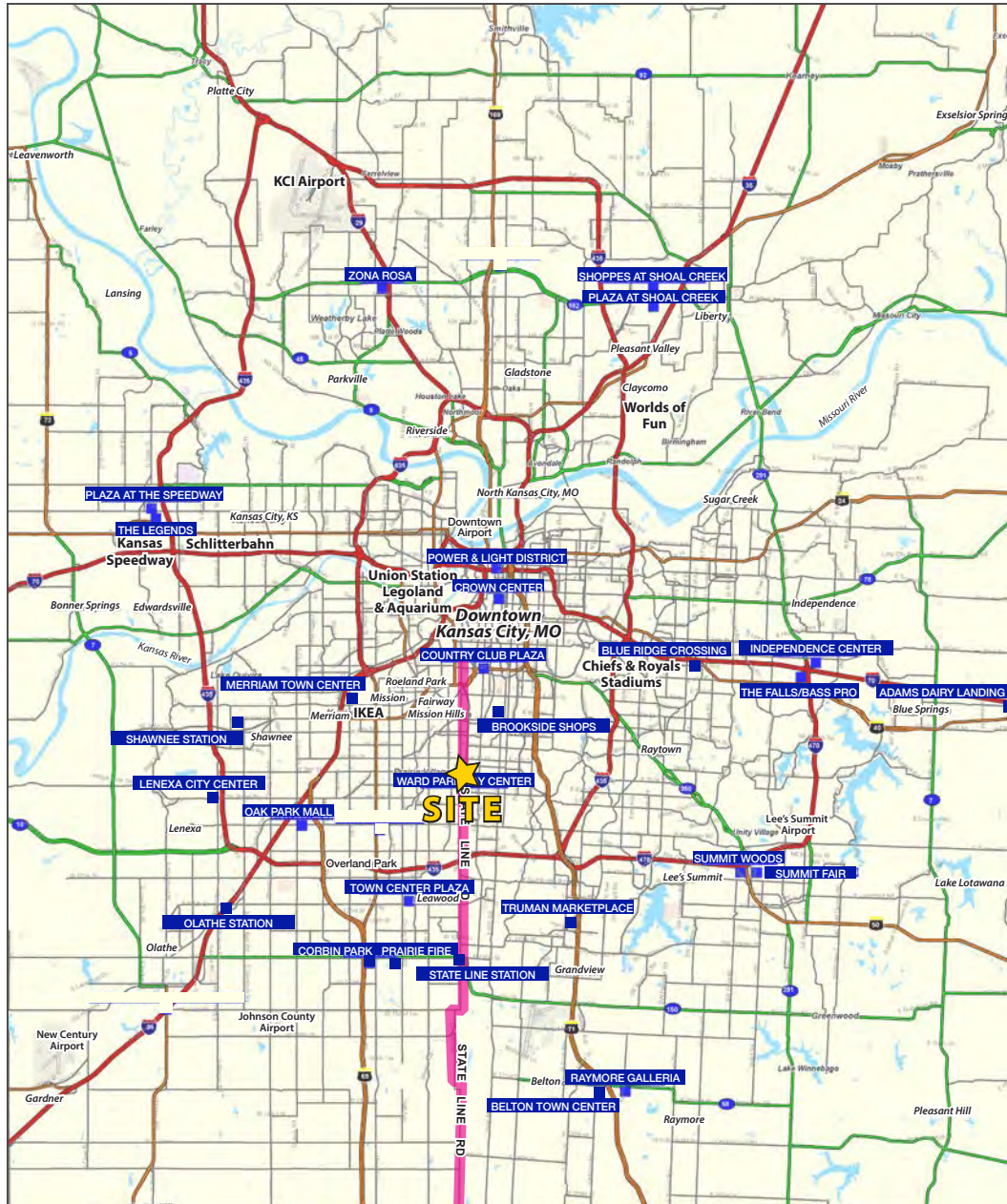



# WARD PARKWAY SHOPPING CENTER

## Pad Building | End Cap Retail Space For Lease

### 89th & State Line Road (NEC), Kansas City, Missouri

8821-8829 State Line Rd

Kansas City, MO 64114

1 mi  
radius

3 mi  
radius

5 mi  
radius

#### Population

2021 Estimated Population	8,368	87,793	227,301
2026 Projected Population	8,389	88,565	228,157
2010 Census Population	8,290	84,932	218,772
2000 Census Population	8,373	88,650	228,816
Projected Annual Growth 2021 to 2026	-	0.2%	-
Historical Annual Growth 2000 to 2021	-	-	-
2021 Median Age	42.6	42.2	41.4

#### Households

2021 Estimated Households	3,880	41,098	102,906
2026 Projected Households	3,953	42,198	105,356
2010 Census Households	3,777	38,739	96,270
2000 Census Households	3,868	39,872	98,881
Projected Annual Growth 2021 to 2026	0.4%	0.5%	0.5%
Historical Annual Growth 2000 to 2021	-	0.1%	0.2%

#### Race and Ethnicity

2021 Estimated White	88.2%	76.5%	72.8%
2021 Estimated Black or African American	5.7%	16.7%	18.7%
2021 Estimated Asian or Pacific Islander	2.3%	2.4%	3.1%
2021 Estimated American Indian or Native Alaskan	0.3%	0.3%	0.4%
2021 Estimated Other Races	3.5%	4.1%	5.0%
2021 Estimated Hispanic	5.1%	5.3%	6.4%

#### Income

2021 Estimated Average Household Income	\$140,250	\$118,366	\$114,097
2021 Estimated Median Household Income	\$98,206	\$90,682	\$86,029
2021 Estimated Per Capita Income	\$65,086	\$55,475	\$51,767

#### Education (Age 25+)

2021 Estimated Elementary (Grade Level 0 to 8)	1.2%	0.8%	1.2%
2021 Estimated Some High School (Grade Level 9 to 11)	0.5%	2.4%	3.0%
2021 Estimated High School Graduate	13.2%	14.1%	16.7%
2021 Estimated Some College	20.2%	18.2%	18.7%
2021 Estimated Associates Degree Only	6.6%	5.6%	6.5%
2021 Estimated Bachelors Degree Only	34.9%	35.4%	32.4%
2021 Estimated Graduate Degree	23.3%	23.4%	21.6%

#### Business

2021 Estimated Total Businesses	628	3,620	10,797
2021 Estimated Total Employees	7,642	48,098	158,642
2021 Estimated Employee Population per Business	12.2	13.3	14.7
2021 Estimated Residential Population per Business	13.3	24.3	21.1

©2021, Sites USA, Chandler, Arizona, 480-491-1112 Demographic Source: Applied Geographic Solutions 5/2021, TIGER Geography - RS1

